

# Mull-It-Over Sound Barrier Mullion Trim Cap Request for Quote Form

(email RFQ form to Austin@mullitoverproducts.com for pricing)

Project Name: \_\_\_\_\_

Project Location: \_\_\_\_\_

Project Architect: \_\_\_\_\_

Delivery Date: \_\_\_\_\_

Check One:  STC 55  STC 60

(4 options)

1 hr Fire Rated  2 hr Fire Rated

SEND QUOTE TO:

Name: \_\_\_\_\_

e-mail: \_\_\_\_\_

Phone: \_\_\_\_\_

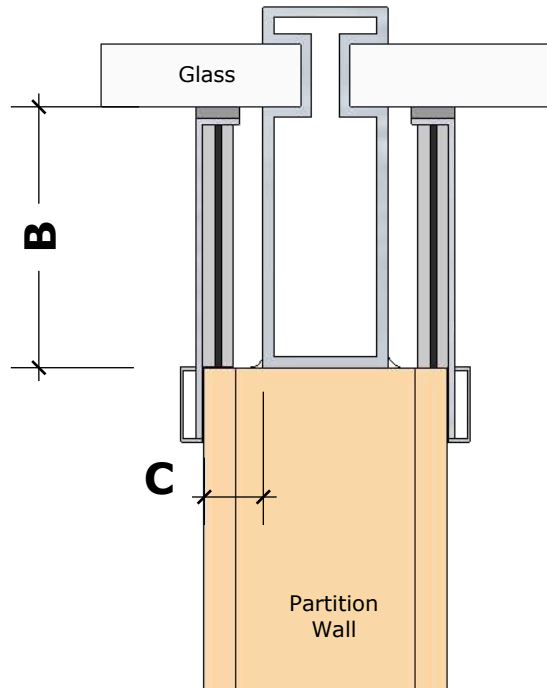
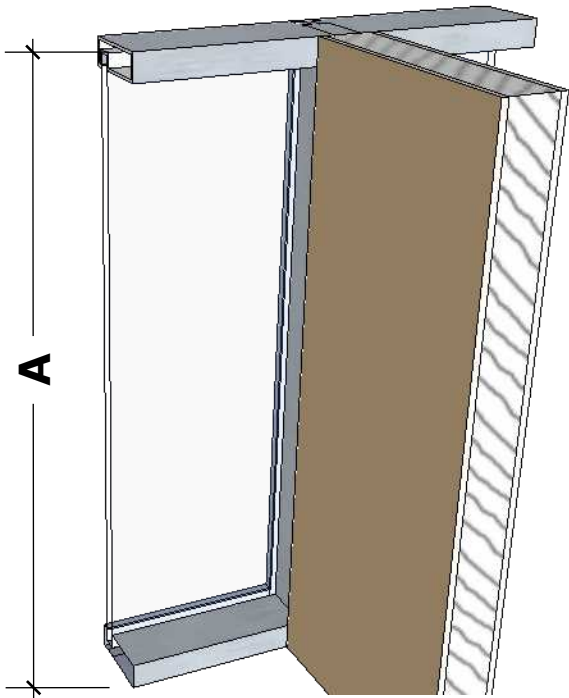

A= \_\_\_\_\_

B= \_\_\_\_\_

C= \_\_\_\_\_

Mullion Cap Profile \_\_\_\_\_

(Classic, Flush or Wide)

\*\*Mullion Cap Quantity \_\_\_\_\_

(see note below)

Mullion Cap Finish \_\_\_\_\_

**Mull-It-Over sound barrier mullion trim caps are custom fabricated. Allow adequate time for fabrication.**

**\*\*Mullion Cap Quantity: Most common detail requires 2 sound barrier mullion trim cap for every partition wall terminated at a vertical mullion.**

Length of Mullion Cap (A) Measure height of vision glass. Add to the length for extending to top or bottom of mullions and sills as detailed by the architect. Recommend ordering the mullion caps long and cutting to length in field to allow for construction tolerance of adjacent systems.

Distance from End of Partition Wall to Interior Face of Glass (B). Maximum distance for a Classic Profile is 8-1/2" and 7-1/2" for a Flush Profile.

Distance from the Face of Mullion to Face of Wall (C) Must be a minimum of 7/8" to use the Classic Profile or Fire Rated Mullion Trim Caps. Select a Mull-It-Over Mullion Trim Cap profile that is compatible.