

Mull-It-Over Sound Barrier Mullion Trim Cap Field Dimension Form

Project Name: _____
 Ship To Address _____

 Project Architect: _____
 Delivery Date: _____

Contractor Contact Info:
 Name: _____
 e-mail: _____
 Phone: _____
 Contact at Project Site: _____

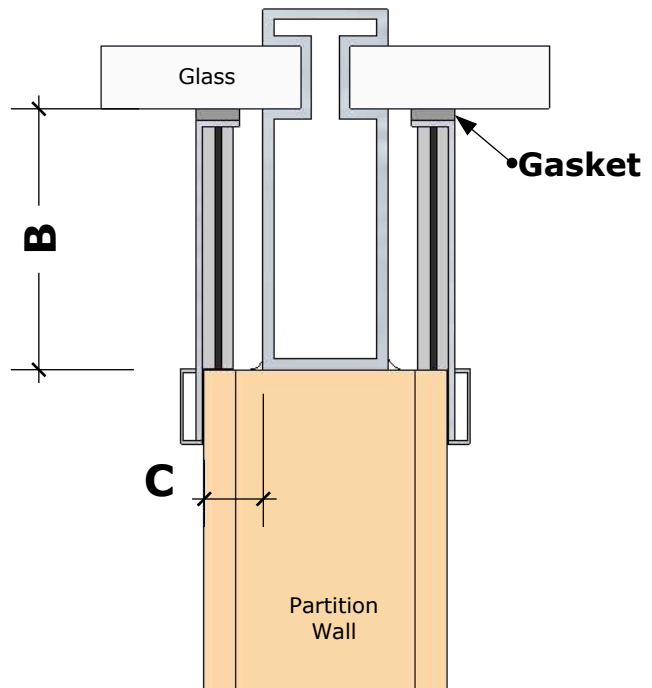
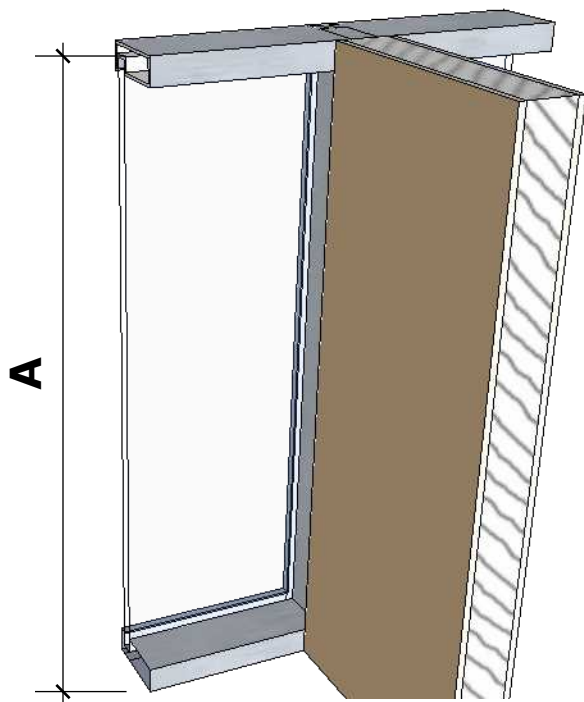

A= _____

B= _____

C= _____

Mullion Cap Profile _____
 (Classic, Flush, Wide, No Mullion or Classic Fire Rated)

Mullion Cap Quantity _____

Mullion Cap Finish _____

Gasket Options: 1/2" Thick 3/4" Thick 1" Thick 1-1/2" Thick Light Gray or Charcoal Color
 (circle selections)

Performance: STC 55 STC 60 STC 60 1 hour Fire Rated STC 60 2 Hour Fire Rated

Length of Mullion Cap (A) Measure height of vision glass. Add to the length for extending to top or bottom of mullions and sills as detailed by the architect. Recommend ordering the mullion caps long and cutting to length in field to allow for construction tolerance of adjacent systems.

Distance from End of Partition Wall to Interior Face of Glass (B) Maximum dimension for a Classic Profile is 8-1/2". Maximum dimension for a Flush Profile is 7-1/2". Maximum dimension for Fire Rated is 8".

Distance from the Face of Mullion to Face of Wall (C) Must be a minimum of 7/8" to use the Classic Profile or Fire Rated Mullion Caps. Select a Mull-It-Over Mullion Trim Cap profile that is compatible. Options are Classic, Flush, Wide, No Mullion Non-Fire Rated and Classic Fire Rated profiles.